

Note 1st. The blue lines on this Map represent the lines of BROAD ST. as defined by the Street Commissioners from the best evidence obtainable. The figures in blue ink indicate the total distance from the beginning of each straight line to the corners of each building &c. and also how much said buildings is ON or OFF the Street according to these lines thus defined.

2d. In the prosecution of this survey, reference has been had to a plot of the lower portion of this Street made by Ben West 1794 & record^d in S.B. 3 p 23 c R^d also Dan Anthony's plot of Broad St. and various other private sources.

3d. At the junction or entrance of High St. an encroachment of several feet on the North side of Broad St. is apparent. The Street should be 4 rods or 66 Ft. wide, as will appear by reference to the plot & report by D. Anthony & others accepted & established by the Town Council May 1st. 1786. The Rich^d Seaver, and the D. Branch house, being acknowledged bounds on the south side.

Note. The lines, Figures &c. in red ink indicate the bounds of the streets as surveyed, bounded and marked out by us, Providence Feb 14th. 1859.

George J. Spier
Amasa Paine
Wm S. Haines

Note. The entrance of High St. has been partly taken from the recent Map of that Street made by W^m S. Haines under the direction of a Committee appointed by the board of Aldermen. The triangular piece of land opposite Chestnut St. A. B. C. was laid out as a public street by the Town Council Nov 11th 1785. C. R. Book 7, p 60. see also petition on file signed by Richard Fenner Bonnet Wheeler & others with reference to the above named point of land. Also a plot rec^d in S. B. 3 p 22.

Note - Drawn on a scale of 40 feet to an inch.
Measurements accord with S. Stan^d.

The red dotted lines indicate the present curbstone and the red figures the distances from the buildings to said lines.

(See P-34)
MAP
OF A PART OF
BROAD STREET

made under the direction of the St. Commiss^{rs}
from a Survey made Oct^r 1858
by
N B SCHUBARTH.

Scale 40

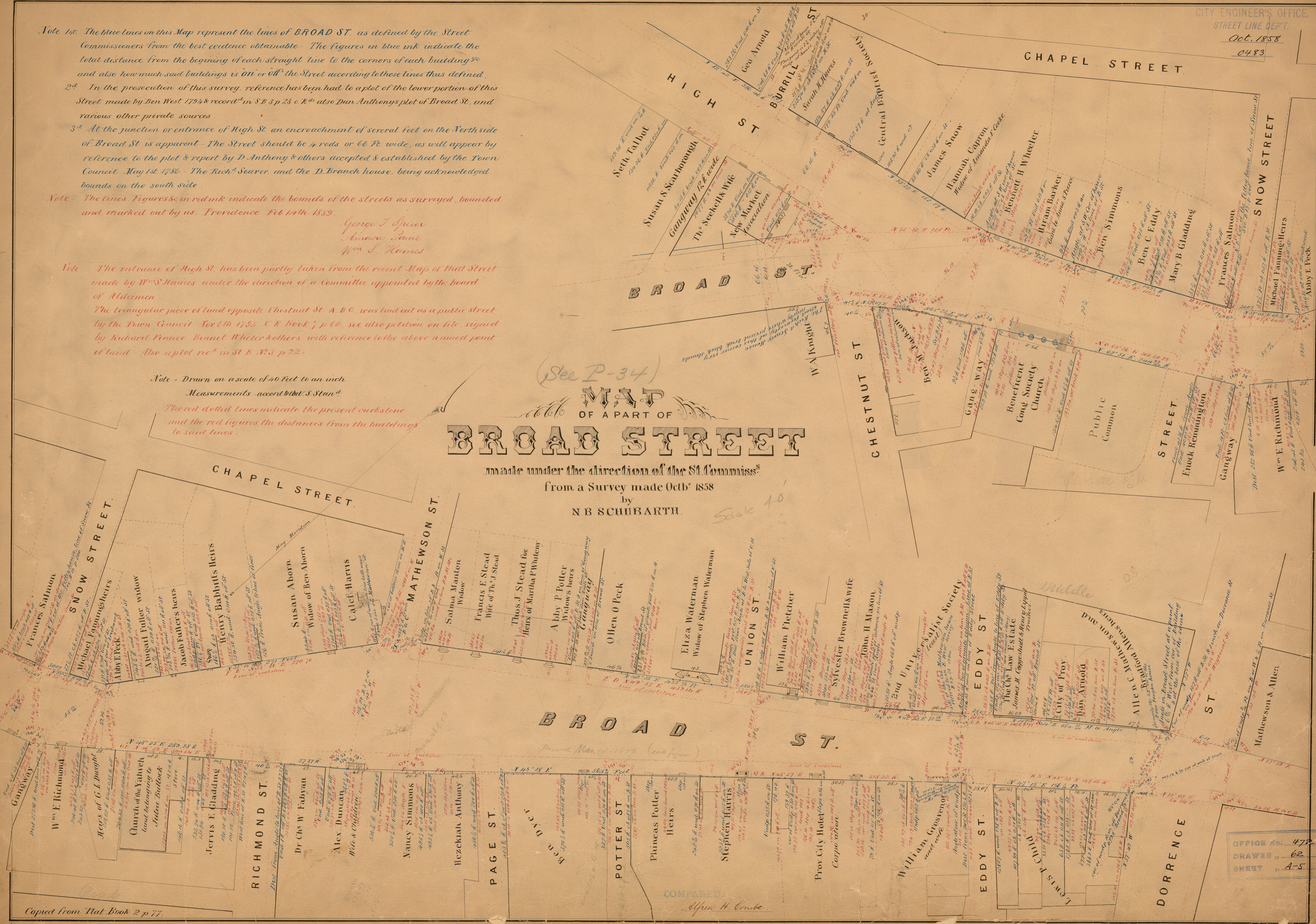

OFFICE No. 472
DRAWER " 62
SHEET " A-5

COMPALED
Alfred H. Combe